

STATE OF FLORIDA
COUNTY OF PALM BEACH
THIS PLAT WAS FILED FOR
RECORD 8-2-2001
THIS 20 DAY OF July
AD, 2001 AND DULY RECORDED
IN PLAT BOOK 47 ON PAGES
29 thru 32
DOROTHY WILKINSON, CLERK
BY: *M. R. King*, D.C.

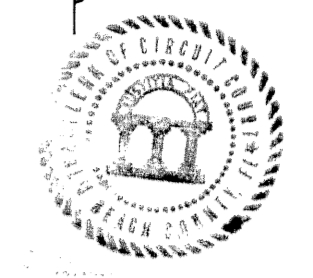

CIRCUIT COURT SEAL

TUSCANY - PARCEL "D-1"

A PLANNED UNIT DEVELOPMENT BEING A PART OF CIBA GEIGY PUD

BEING A REPLAT OF TRACTS 9 & 10 OF BLOCK 48, PALM BEACH FARMS COMPANY PLAT NO. 3, AS RECORDED IN PLAT BOOK 2, PAGES 45-54, PUBLIC RECORDS OF PALM BEACH COUNTY, FLORIDA, TOGETHER WITH TRACT "L" OF THE PLAT OF TUSCANY PARCEL "D", AS RECORDED IN PLAT BOOK 84, PAGES 167-170, PUBLIC RECORDS OF PALM BEACH COUNTY, FLORIDA, LYING IN SECTION 22, TOWNSHIP 45 SOUTH, RANGE 42 EAST PALM BEACH COUNTY, FLORIDA.

MAY, 2001 SHEET 1 OF 4

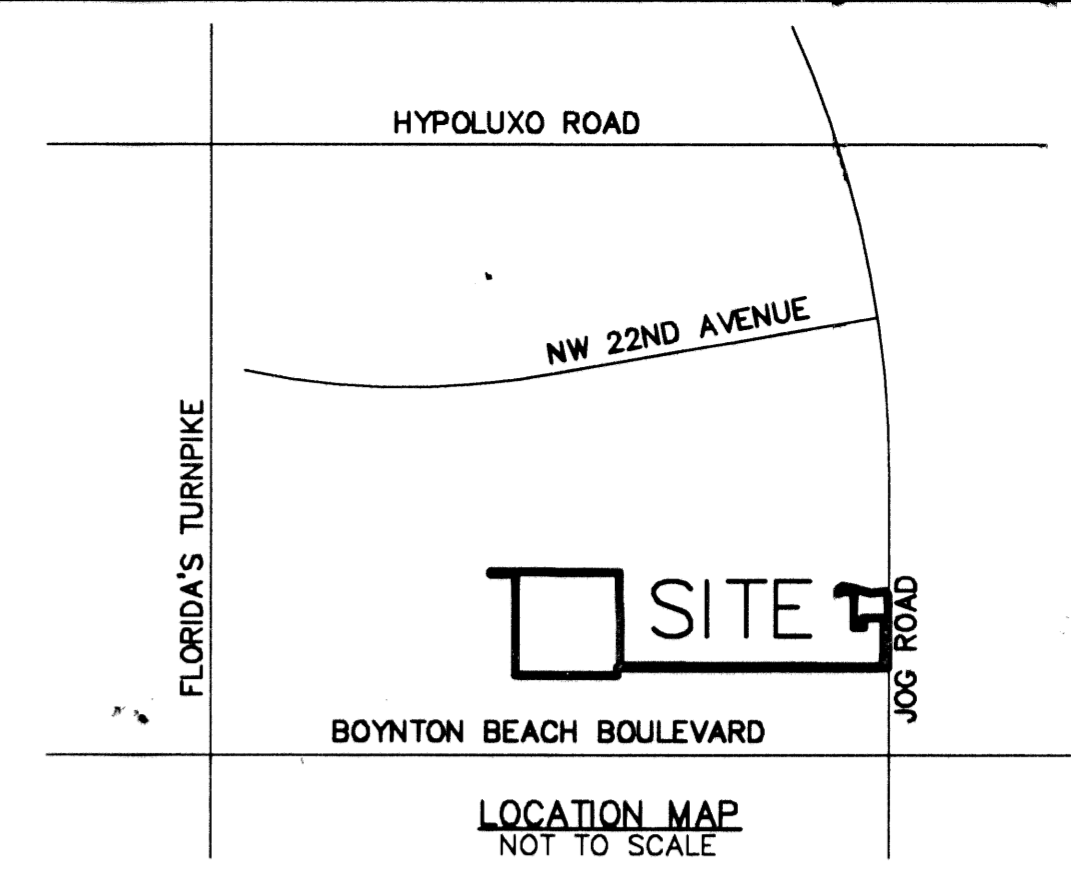
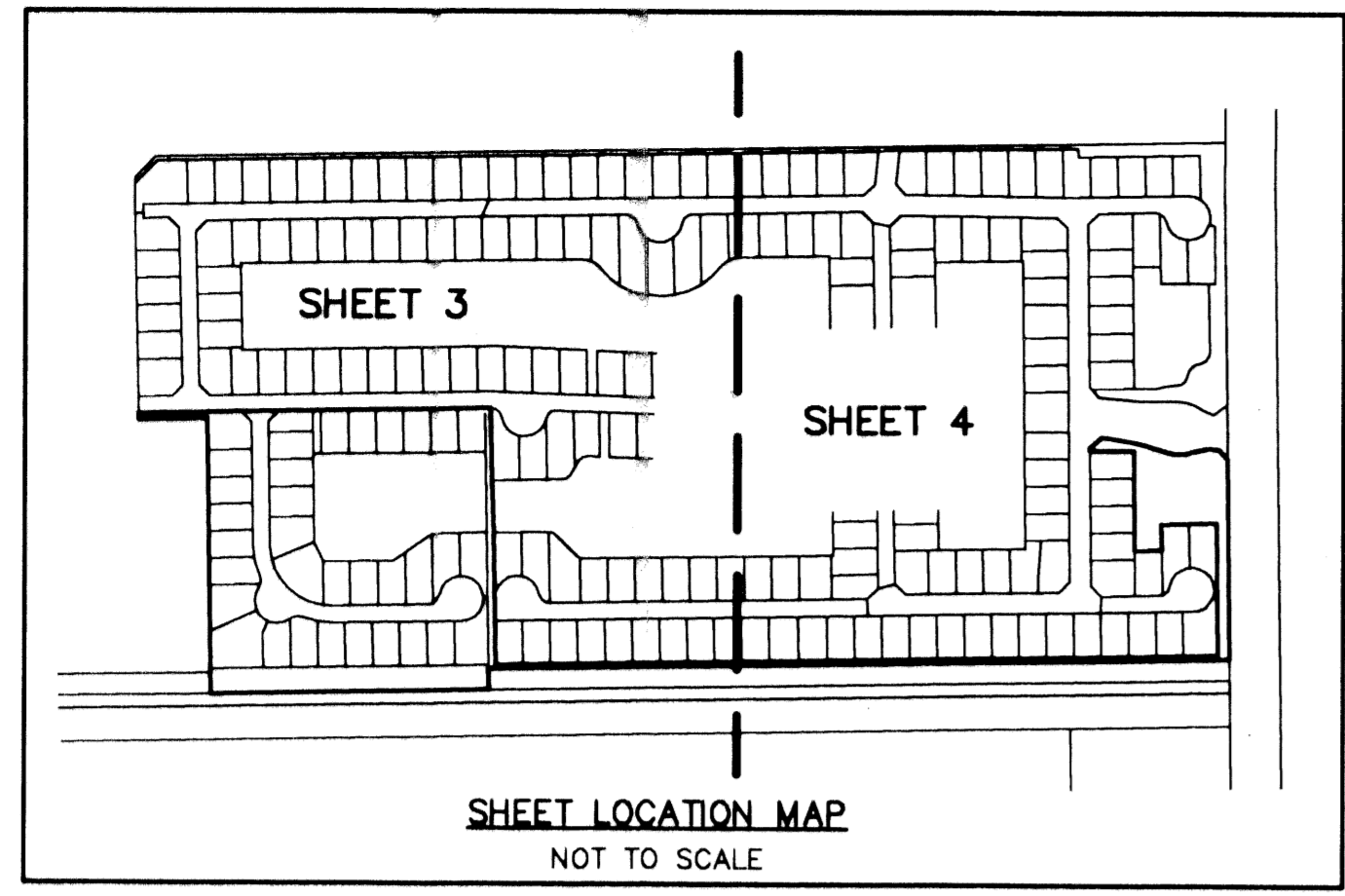

DEDICATION

KNOW ALL MEN BY THESE PRESENTS THAT LEVITT HOMES INCORPORATED, A DELAWARE CORPORATION, LICENSED TO DO BUSINESS IN FLORIDA, THE OWNER OF THE LAND SHOWN HEREON AS TUSCANY PARCEL "D-1", BEING A REPLAT OF TRACTS 9 & 10 OF BLOCK 48, PALM BEACH FARMS COMPANY PLAT NO. 3, AS RECORDED IN PLAT BOOK 2, PAGES 45-54, PUBLIC RECORDS OF PALM BEACH COUNTY, FLORIDA, TOGETHER WITH TRACT "L" OF THE PLAT OF TUSCANY PARCEL "D", AS RECORDED IN PLAT BOOK 84, PAGES 167-170, PUBLIC RECORDS OF PALM BEACH COUNTY, FLORIDA, LYING IN SECTION 22, TOWNSHIP 45 SOUTH, RANGE 42 EAST, ALL OF THE PUBLIC RECORDS OF PALM BEACH COUNTY, FLORIDA, BEING MORE PARTICULARLY DESCRIBED AS FOLLOWS:

ALL OF TRACTS 9 AND 10, BLOCK 48, PALM BEACH FARMS COMPANY PLAT NO. 3, ACCORDING TO THE PLAT THEREOF AS RECORDED IN PLAT BOOK 2, PAGES 45-54 INCLUSIVE OF THE PUBLIC RECORDS OF PALM BEACH COUNTY, FLORIDA.

TOGETHER WITH:

ALL OF TRACT "L" OF THE PLAT OF TUSCANY PARCEL "D", AS RECORDED IN PLAT BOOK 84, PAGES 167-170, OF THE PUBLIC RECORDS OF PALM BEACH COUNTY, FLORIDA.

CONTAINING 530,007 SQUARE FEET OR 12.167 ACRES, MORE OR LESS.

HAVE CAUSED THE SAME TO BE SURVEYED AND PLATTED AS SHOWN HEREON AND DO HEREBY DEDICATE AS FOLLOWS:

1. TRACT A, AS SHOWN HEREON, IS HEREBY RESERVED FOR THE TUSCANY ISLES RESIDENTS ASSOCIATION, INC., ITS SUCCESSORS AND ASSIGNS, AS A RESIDENTIAL ACCESS STREET FOR PRIVATE STREET PURPOSES AND OTHER PURPOSES NOT INCONSISTENT WITH THIS RESERVATION AND IS THE PERPETUAL MAINTENANCE OBLIGATION OF SAID ASSOCIATION, ITS SUCCESSORS AND ASSIGNS, WITHOUT RECOURSE TO PALM BEACH COUNTY.

2. TRACTS C AND D, AS SHOWN HEREON, ARE HEREBY RESERVED FOR THE TUSCANY ISLES RESIDENTS ASSOCIATION, INC., ITS SUCCESSORS AND ASSIGNS, FOR OPEN SPACE PURPOSES, AND ARE THE PERPETUAL MAINTENANCE OBLIGATION OF SAID ASSOCIATION, ITS SUCCESSORS AND ASSIGNS, WITHOUT RECOURSE TO PALM BEACH COUNTY.

3. TRACT H, AS SHOWN HEREON, IS HEREBY RESERVED FOR THE TUSCANY ISLES RESIDENTS ASSOCIATION, INC., ITS SUCCESSORS AND ASSIGNS, FOR OPEN SPACE PURPOSES, AND IS THE PERPETUAL MAINTENANCE OBLIGATION OF SAID ASSOCIATION, ITS SUCCESSORS AND ASSIGNS, WITHOUT RECOURSE TO PALM BEACH COUNTY. SUBJECT TO THE RESTRICTIONS SET FORTH IN OFFICIAL RECORDS BOOK 1859, PAGES 1655 THROUGH 1658, INCLUSIVE, OF THE PUBLIC RECORDS OF PALM BEACH COUNTY, FLORIDA, IN FAVOR OF LAKE WORTH DRAINAGE DISTRICT.

4. TRACT LK-1, THE WATER MANAGEMENT TRACT, AS SHOWN HEREON, IS HEREBY RESERVED FOR THE TUSCANY ISLES RESIDENTS ASSOCIATION, INC., ITS SUCCESSORS AND ASSIGNS, FOR STORMWATER MANAGEMENT AND DRAINAGE PURPOSES AND IS THE PERPETUAL MAINTENANCE OBLIGATION OF SAID ASSOCIATION, ITS SUCCESSORS AND ASSIGNS, WITHOUT RECOURSE TO PALM BEACH COUNTY. SUBJECT TO EXISTING LITTORAL ZONE RESTRICTIVE COVENANT AGREEMENT AS RECORDED IN OFFICIAL RECORD BOOK 1859, PAGES 1655 THROUGH 1658, INCLUSIVE, OF THE PUBLIC RECORDS OF PALM BEACH COUNTY, FLORIDA.

PALM BEACH COUNTY SHALL HAVE THE RIGHT, BUT NOT THE OBLIGATION, TO MAINTAIN ANY PORTION OF THE DRAINAGE SYSTEM ENCOMPASSED BY THIS PLAT WHICH IS ASSOCIATED WITH THE DRAINAGE OF PUBLIC STREETS, INCLUDING THE RIGHT TO UTILIZE FOR PROPER PURPOSES ANY AND ALL DRAINAGE, LAKE MAINTENANCE, AND LAKE MAINTENANCE ACCESS EASEMENTS AND PRIVATE ROADS ASSOCIATED WITH SAID DRAINAGE SYSTEM.

5. THE ZERO LOT LINE MAINTENANCE EASEMENTS (ZLLME), AS SHOWN HEREON, ARE HEREBY RESERVED FOR THE ABUTTING LOT OWNER, THEIR SUCCESSORS AND ASSIGNS, FOR MAINTENANCE OF ROOF OVERHANGS, WITHOUT RECOURSE TO PALM BEACH COUNTY.

6. THE UTILITY EASEMENTS (UE), AS SHOWN HEREON, ARE HEREBY DEDICATED IN PERPETUITY FOR THE CONSTRUCTION AND MAINTENANCE OF UTILITY FACILITIES, INCLUDING CABLE TELEVISION SYSTEMS, THE INSTALLATION OF CABLE TELEVISION SYSTEMS SHALL NOT INTERFERE WITH THE CONSTRUCTION AND MAINTENANCE OF OTHER UTILITIES.

7. THE BUFFER TRACTS B, E AND F, AS SHOWN HEREON, ARE HEREBY RESERVED FOR THE TUSCANY ISLES RESIDENTS ASSOCIATION, INC., ITS SUCCESSORS AND ASSIGNS, FOR BUFFER PURPOSES AND IS THE PERPETUAL MAINTENANCE OBLIGATION OF SAID ASSOCIATION, ITS SUCCESSORS AND ASSIGNS, WITHOUT RECOURSE TO PALM BEACH COUNTY.

8. THE LANDSCAPE TRACT G, AS SHOWN HEREON, IS HEREBY RESERVED FOR THE TUSCANY ISLES RESIDENTS ASSOCIATION, INC., ITS SUCCESSORS AND ASSIGNS, FOR LANDSCAPE PURPOSES AND IS THE PERPETUAL MAINTENANCE OBLIGATION OF SAID ASSOCIATION, ITS SUCCESSORS AND ASSIGNS, WITHOUT RECOURSE TO PALM BEACH COUNTY.

9. THE DRAINAGE EASEMENTS AS SHOWN HEREON ARE HEREBY DEDICATED IN PERPETUITY FOR DRAINAGE PURPOSES, THE MAINTENANCE OF ALL DRAINAGE FACILITIES LOCATED THEREIN SHALL BE THE PERPETUAL MAINTENANCE OBLIGATION OF THE TUSCANY ISLES RESIDENTS ASSOCIATION, INC., ITS SUCCESSORS AND ASSIGNS, WITHOUT RECOURSE TO PALM BEACH COUNTY.

10. THE LAKE MAINTENANCE EASEMENTS (LME), AS SHOWN HEREON, ARE HEREBY RESERVED FOR THE TUSCANY ISLES RESIDENTS ASSOCIATION, INC., ITS SUCCESSORS AND ASSIGNS, FOR ACCESS TO STORMWATER MANAGEMENT AND DRAINAGE FACILITIES LOCATED WITHIN THE ASSOCIATED WATER MANAGEMENT TRACT FOR THE PURPOSES OF PERFORMING ANY AND ALL MAINTENANCE ACTIVITIES PURSUANT TO THE MAINTENANCE OBLIGATION OF SAID ASSOCIATION, ITS SUCCESSORS AND ASSIGNS, WITHOUT RECOURSE TO PALM BEACH COUNTY.

PALM BEACH COUNTY SHALL HAVE THE RIGHT, BUT NOT THE OBLIGATION, TO MAINTAIN ANY PORTION OF THE DRAINAGE SYSTEM ENCOMPASSED BY THIS PLAT WHICH IS ASSOCIATED WITH THE DRAINAGE OF PUBLIC STREETS, INCLUDING THE RIGHT TO UTILIZE FOR PROPER PURPOSES ANY AND ALL DRAINAGE, LAKE MAINTENANCE, AND LAKE MAINTENANCE ACCESS EASEMENTS AND PRIVATE STREETS ASSOCIATED WITH SAID DRAINAGE SYSTEM.

11. THE LIMITED ACCESS EASEMENTS AS SHOWN HEREON ARE HEREBY DEDICATED TO THE BOARD OF COUNTY COMMISSIONERS OF PALM BEACH COUNTY, FLORIDA, FOR THE PURPOSE OF CONTROL AND JURISDICTION OVER ACCESS RIGHTS.

IN WITNESS WHEREOF, THE ABOVE NAMED CORPORATION HAS CAUSED THESE PRESENTS TO BE SIGNED BY ITS SENIOR VICE PRESIDENT AND ITS CORPORATE SEAL TO BE AFFIXED HERETO BY AND WITH THE AUTHORITY OF ITS BOARD OF DIRECTORS, THIS 1 DAY OF May, 2001.

LEVITT HOMES INCORPORATED,
A DELAWARE CORPORATION,
LICENSED TO DO BUSINESS IN FLORIDA
WITNESS: *Janna Griffin* BY: *H. T. Slek*
HARRY T. SLEEK
SENIOR VICE PRESIDENT

WITNESS: *A. S. S. S. S.*

ACKNOWLEDGEMENT

STATE OF FLORIDA)
COUNTY OF PALM BEACH)

BEFORE ME PERSONALLY APPEARED HARRY T. SLEEK WHO IS PERSONALLY KNOWN TO ME, OR HAS PRODUCED _____ AS IDENTIFICATION, AND WHO EXECUTED THE FOREGOING INSTRUMENT AS SENIOR VICE PRESIDENT OF LEVITT HOMES, INCORPORATED, A DELAWARE CORPORATION, AND SEVERALLY ACKNOWLEDGED TO AND BEFORE ME THAT HE EXECUTED SUCH INSTRUMENT AS SUCH OFFICER OF SAID CORPORATION, AND THAT THE SEAL AFFIXED TO THE FOREGOING INSTRUMENT IS THE CORPORATE SEAL OF SAID CORPORATION AND THAT IT WAS AFFIXED TO SAID INSTRUMENT BY DUE AND REGULAR CORPORATE AUTHORITY, AND THAT SAID INSTRUMENT IS THE FREE ACT AND DEED OF SAID CORPORATION.

WITNESS MY HAND AND OFFICIAL SEAL THIS 1st DAY OF May, 2001.
MY COMMISSION EXPIRES: 4-30-02 DATE *Barbara Spence* NOTARY PUBLIC

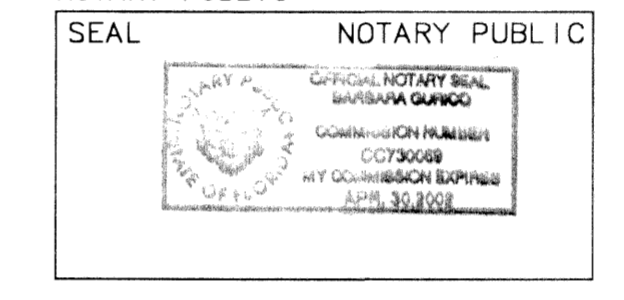

ACCEPTANCE OF RESERVATIONS

STATE OF FLORIDA)
COUNTY OF PALM BEACH)

THE TUSCANY ISLES RESIDENTS ASSOCIATION, INC., HEREBY ACCEPTS THE DEDICATIONS OR RESERVATIONS TO SAID ASSOCIATION AS STATED AND SHOWN HEREON, AND HEREBY ACCEPTS ITS MAINTENANCE OBLIGATIONS FOR SAME AS STATED HEREON, DATED THIS 1 DAY OF May, 2001.

TUSCANY ISLES RESIDENTS ASSOCIATION, INC., A FLORIDA CORPORATION NOT FOR PROFIT
WITNESS: *Janna Griffin* BY: *H. T. Slek*
HARRY T. SLEEK, PRESIDENT

ACKNOWLEDGEMENT

STATE OF FLORIDA)
COUNTY OF PALM BEACH)

BEFORE ME PERSONALLY APPEARED HARRY T. SLEEK WHO IS PERSONALLY KNOWN TO ME, OR HAS PRODUCED _____ AS IDENTIFICATION, AND WHO EXECUTED THE FOREGOING INSTRUMENT AS PRESIDENT OF TUSCANY ISLES RESIDENTS ASSOCIATION, INC., A FLORIDA CORPORATION NOT FOR PROFIT, AND SEVERALLY ACKNOWLEDGED TO AND BEFORE ME THAT HE EXECUTED SUCH INSTRUMENT AS SUCH OFFICER OF SAID CORPORATION, AND THAT THE SEAL AFFIXED TO THE FOREGOING INSTRUMENT IS THE CORPORATE SEAL OF SAID CORPORATION AND THAT IT WAS AFFIXED TO SAID INSTRUMENT BY DUE AND REGULAR CORPORATE AUTHORITY, AND THAT SAID INSTRUMENT IS THE FREE ACT AND DEED OF SAID CORPORATION.

WITNESS MY HAND AND OFFICIAL SEAL THIS 1 DAY OF May, 2001.
MY COMMISSION EXPIRES: 4-30-02 DATE *Barbara Spence* NOTARY PUBLIC

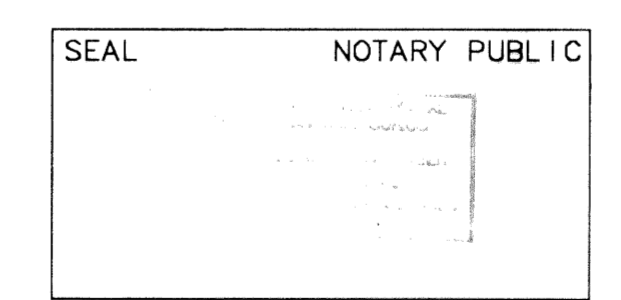

LEGEND:

- BE = BUFFER EASEMENT
- DB = DEED BOOK
- D = DELTA (CENTRAL) ANGLE
- DE = DRAINAGE EASEMENT
- FND = FOUND
- L = ARC LENGTH
- LME = LAKE MAINTENANCE EASEMENT
- NO. = NUMBER
- NR = NON-RADIAL
- OHME = OVERHANG MAINTENANCE EASEMENT
- ORB = OFFICIAL RECORD BOOK
- PB = PLAT BOOK
- PG(S) = PAGE(S)
- POB = POINT OF BEGINNING
- PUD = PLANNED UNIT OF DEVELOPMENT
- R = RADIUS
- R/W = RIGHT-OF-WAY
- (TYP) = TYPICAL
- UE = UTILITY EASEMENT
- = SET 4"x4" CONCRETE MONUMENT "LB#7055"
- = SET PERMANENT CONTROL POINT "LB#7055" UNLESS OTHERWISE SHOWN

SEAL
LEVITT HOMES
INCORPORATED

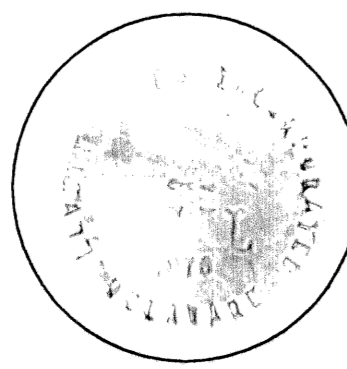

SEAL
TUSCANY ISLES
RESIDENTS ASSOC., INC.

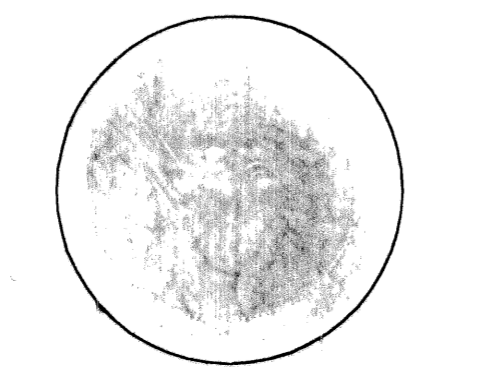

SEAL
COUNTY ENGINEER

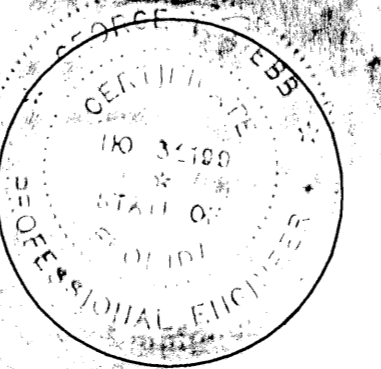

SUBDIVISION: Tuscany - Parcel "D-1"
PAGE: 29
FLOOD MAP # 1859
ZONING: R-1
QUAD # 35
SS
TAB # 443
PUD NAME: CIBA GEIGY PUD

W Wantman Group, Inc.
Engineering ♦ Surveying ♦ Mapping
901 NORTHPOINT PARKWAY, SUITE 204
WEST PALM BEACH, FL 33407
(561) 687-2220 phone (561) 687-1110 fax
CERT No. 6091 - LB No. 7055

CAD	K:\LEVIT\TUSCANY\DWG\TUSCRP04			
REF	K:\LEVIT\TUSCANY\DWG\TUSCMG01			
FLD	RP/AB	FB. 000	PG. 00	JOB 00-036A
OFF	AJP			DATE 01/31/01
CKD	BBP	SHEET 1 OF 4	DWG 00-020	